

Mundy Park Trails

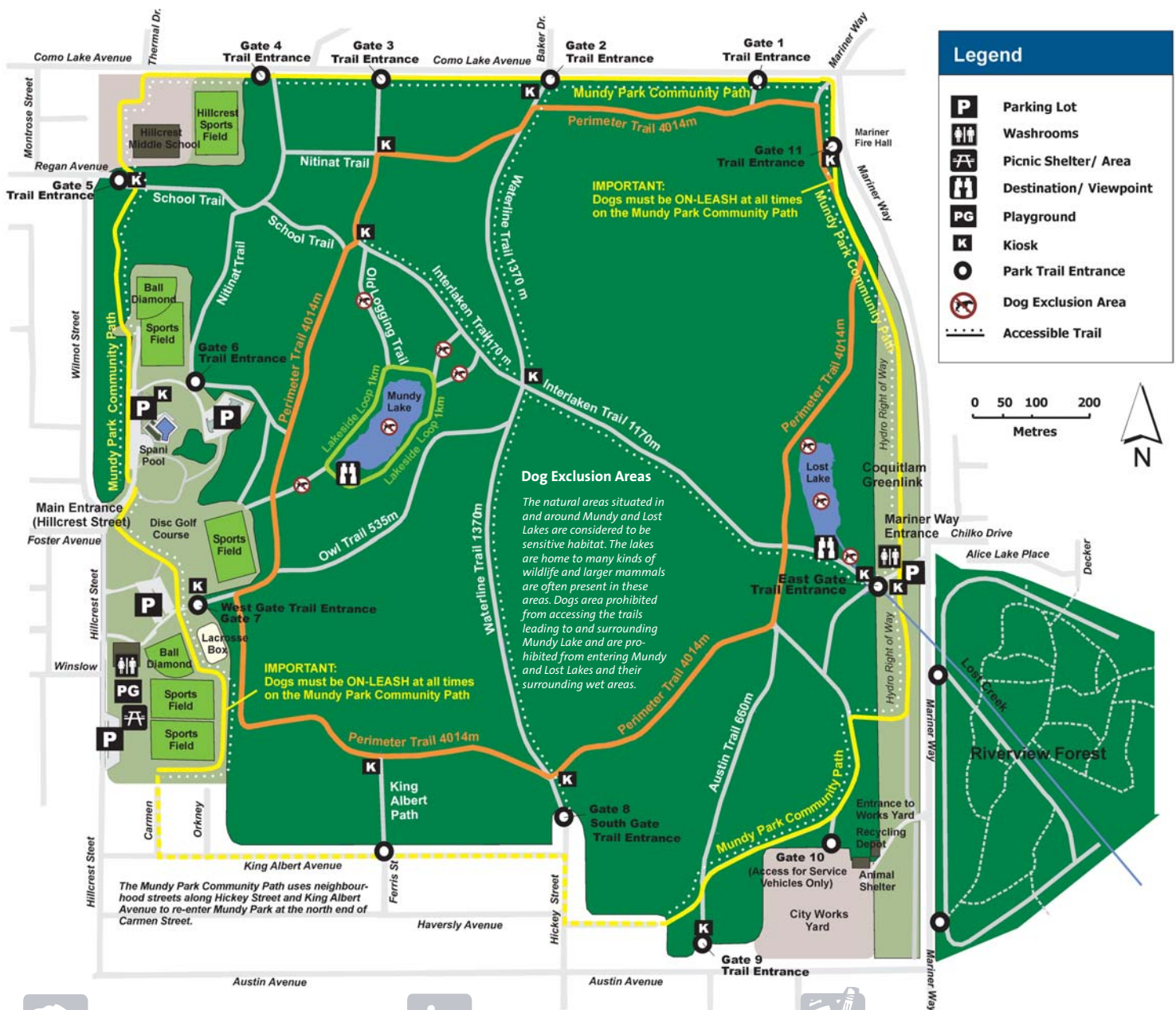

Wildlife

When venturing into Mundy Park always remember that you are a visitor to wildlife habitat. Mundy Park is known to be frequently visited by larger animals such as bears, coyotes and deer. Do not provoke or startle wildlife and never leave food or garbage on the trails. Make your presence known by talking loudly, clapping or occasionally singing. For more information on bear safety visit www.coquitlam.ca

Accessible Trails

Accessible trail is the term given to trails with a surface that allows for easy access and mobility for wheelchairs. Portions of the Mundy Park Community Path, Waterline Trail and Interlaken Trails are considered to be accessible. For more information on wheelchair accessibility please call 604-927-3546.

Trails identified with an adjacent dashed line are trails that are considered to be accessible trails.

Nature Guidebook

In conjunction with the City of Coquitlam, the Friends of Mundy Park Heritage Society generated a Nature Trail Guidebook for Mundy Park, which provides nature enthusiasts with a guide to the flora and fauna of Mundy Park. The Friends in Mundy Park Heritage Society are a group of dedicated volunteers who contribute to the maintenance and the preservation of Mundy Park. For more information please call 604-933-6226.